



Prismatic LiFePO4 batteries M6 terminal/busbar cover

 **TomHC**

[VIEW IN BROWSER](#)

updated 8. 12. 2025 | published 8. 12. 2025

Summary

To avoid risk of unwanted short circuit, for batteries with single M6 stud / wrench no. 10, with hole for BMS cable .

[Hobby & Makers](#) > [Electronics](#)

Tags: [lifepo4](#) [terminal](#) [busbar](#) [lfp](#)

PETG should be used as non-flammable or less-flammable material. 15% infill is enough.

This remix is based on



CALB CA series LiFePO4 battery terminal cover

by [mondo](#)

Model files

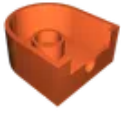

lfp-terminal-cover-m6-m10-nut.stl

License

This work is licensed under a
[Creative Commons \(International License\)](#)



Public Domain

-
- ✓ | Sharing without ATTRIBUTION
 - ✓ | Remix Culture allowed
 - ✓ | Commercial Use
 - ✓ | Free Cultural Works
 - ✓ | Meets Open Definition